

Meriden Development Newsletter

Welcome to the first issue of Meriden development newsletter. This newsletter, and others in the future, will give you the chance to find out more information about the plans and progression of the works being undertaken as part of the regeneration of the Meriden.



Construction of the first 3 new Bungalows

Works to foundations, drainage and brickwork are due to start on 10th September 2018 , and are expected to be completed by June 2019.

In mid-September, we will consult with the current bungalow residents, so we can discuss the both the design and decoration options they are able to choose for their new home, and the details of the move itself.

Demolition works

The demolition of the garage blocks next to Foxtree House and Maple Court is now complete, which has made way for the new apartment blocks F1 and F2.

Foundation works to Block F1 & F2

Following investigations around the existing garages adjacent to Foxtree House and Maple Court, the initial proposal was to underpin the existing foundations to Foxtree House and Maple Court to enable the new apartment blocks F1 & F2 to be constructed. However, after further design reviews alternative and less disruptive foundation design solutions were considered. After this review we now intend to use a "piled raft" foundation which is a quicker construction method and avoids the need to underpin the existing foundations. Subject to statutory approvals these works will commence at the beginning of October 2018.

The plan below outlines the summary of works proposed by Mulalley

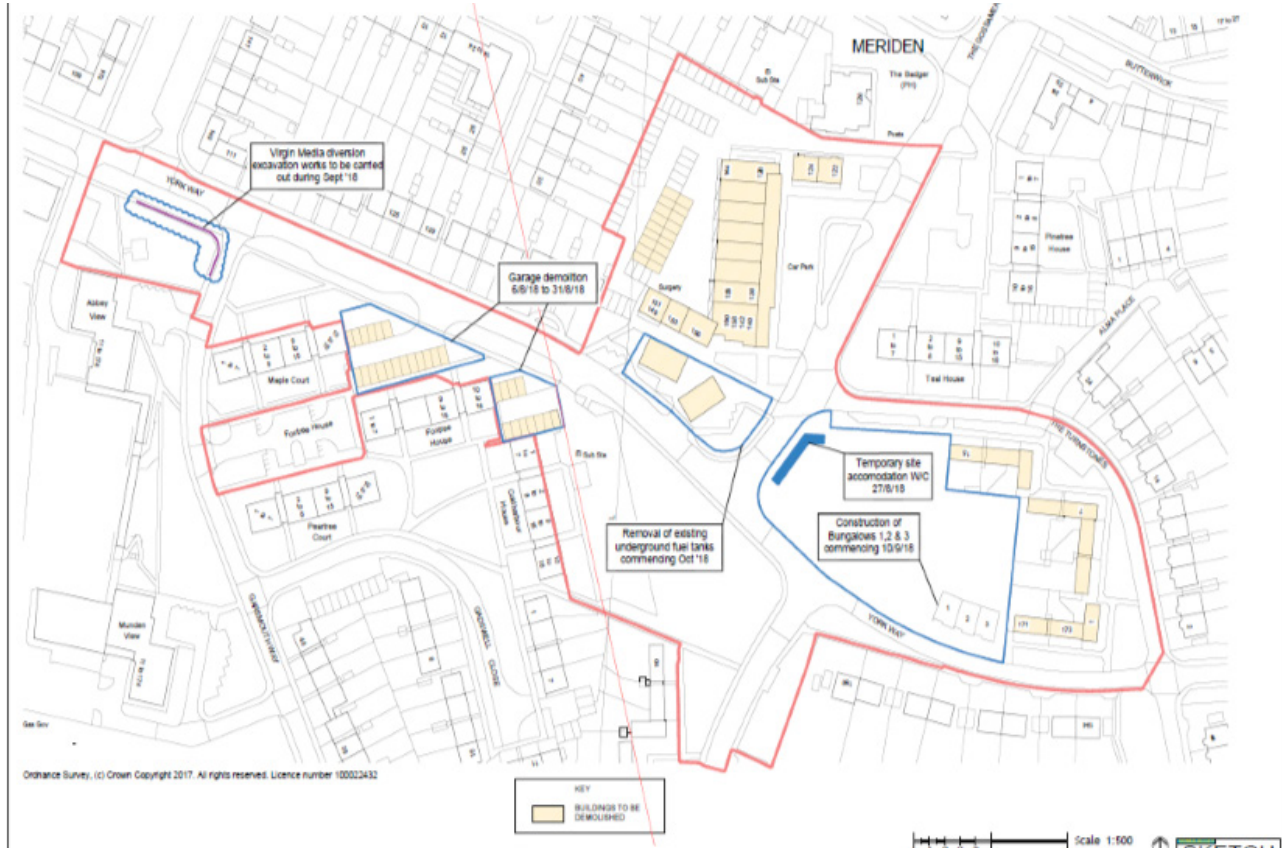

Site cabins and welfare facilities

Site cabins are currently being installed in the site compound area. These works are due to start on the 27th August and are expected to be complete on 31st August 2018.

Watford Community Housing will give Mulalley possession of Work Area 2, which includes construction of Block G, F1, F2 and E2/E3 (see plan right), on 10th September.

The plan below outlines Area 2 works



Completion of Virgin Media Diversion Excavation Works (adjacent to Abbey View)

The exact start date is yet to be confirmed by Virgin Media but these works are expected to be complete during September 2018.





Removal of underground fuel tanks to the old MOT Garage site

These works will start early October 2018 and will take approximately 3 weeks to complete. There will be a programme of long term monitoring by Mulalley, which includes installing boreholes in the ground on the green and on Meriden Way. These will then be reviewed before construction of the new extra care scheme.

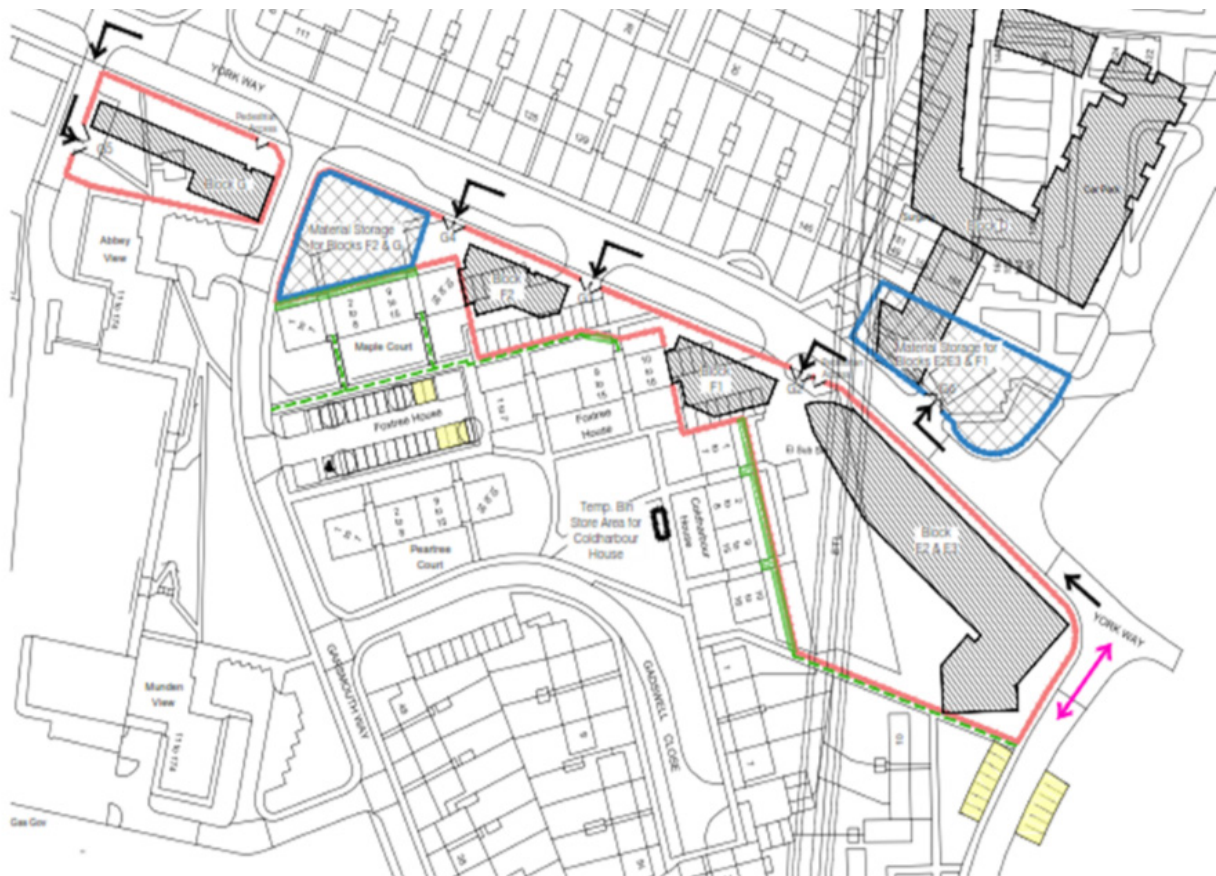
Work Area 2 Site Set Up Arrangements

The initial works Mulalley will undertake will include forming temporary access routes to the existing buildings, re-aligning the current vehicle access to the car park adjacent to Coldharbour House and erecting of site hoardings (see plan below).



Key:		Site access points
		Temporary access routes to existing properties during construction works
		Hoardings arrangements during construction works
		Material storage areas

Your views : New Road and block names

We're going to be asking local residents their thoughts on potential names for the following:

- The new road between York Way and The Turnstones. We would like to keep with the theme of 'water birds'.
- The names of the new apartment block buildings

Also, if you are interested in creating some artwork on the hoarding around the estate, please get in touch so we can share more information with you!

If you have any suggestions for road and block names or for the hoarding, please send them to Mary Robinson at: (email) mary.robinson@wcht.org.uk or (mobile) 07843 371 051

Contact details

To find out more about the regeneration you can contact:



Mary Robinson—Senior Project Manager
Watford Community Housing
Tel: 01923 209041
Mobile: 07843 371051
Email: mary.robinson@wcht.org.uk



Danny O'Reilly — Associate Director
Mulalley
Mobile: 07733 120053
Email: danny.oreilly@mulalley.co.uk



Rob Schofield —Senior Project Manager
Mulalley
Mobile: 07827 884 510
Email: rob.schofield@mulalley.co.uk